

# Medical gas devices

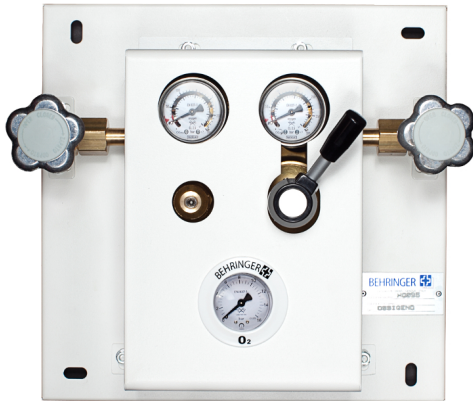

## Semiautomatic EURO/A control module

### Product description

Control module for medical gases, with automatic switching and manual reset using the lever on the pressure regulator to restore priority of use of the source. If one of the two sources is discharged, the system is fed automatically from the other source. The module has two EURO regulators, a CW614N brass pressure gauge, two High Pressure shut-off valves, two overpressure discharge valves integrated into the pressure regulators, that can be connected with a Ø 12 mm weld-on pipe connector and two Low Pressure shut-off valves for servicing. Low Pressure gauge on the outlet to measure line pressure. The inlet connection is

specific for the gas used, the outlet is fitted with a Ø 16 mm weld-on pipe connector. Its maximum nitrogen capacity at 9 bar outlet pressure is 72 Nm<sup>3</sup>/h, 1200 NI/min. The two pressure regulator High Pressure gauges have electrical contacts, are pre-calibrated with a 15 bar alarm threshold and can be connected to an alarm control unit to signal manifold empty. The control module is protected from atmospheric agents by a white painted steel box with transparent PLEXIGLAS windows for checking the pressure gauges. For easy wall mounting, all components are installed on a white painted steel plate.

### Normatives

UNI EN ISO 10524-2:2006 | UNI EN ISO 9001:2008 | UNI CEI EN ISO 14971:2012 | UNI CEI EN ISO 13485:2004 | UNI EN ISO 15001:2012

### Components

- N. Two EURO High Pressure regulators, the body of which is made of CW614N brass and stainless steel pressure adjustment set screw.
- N. Two overpressure discharge valves, integrated into the pressure regulators, made of CW614N brass.
- N. Two gas-specific inlets.
- N. One outlet with Ø16 mm weld-on pipe connector.
- N. Two CW614N brass High Pressure shut-off valves.
- N. Two Low Pressure shut-off valves for servicing.
- N. Two High Pressure gauges with electrical contacts, range 0-315 bar, class 2.5.
- N. One Low Pressure gauge, range 0-16 bar, class 2.5.
- N. Two sintered bronze inlet filters (filtration grade < 100 µm).
- Stainless steel springs.
- VITON O-Ring for O<sub>2</sub>, NBR O-ring for other gases.
- NYLON seal seat for O<sub>2</sub>, TEFLON seal seat for other gases.
- VITON O-Ring for O<sub>2</sub>, NBR O-ring for other gases.
- Nylon gaskets.
- White painted steel cover.

White painted steel fixing plate.

## Product codes

GAS	CODE
OXYGEN	HQ095
AIR	HQ096
NITROUS OXIDE	HQ097
CARBON DIOXIDE	HQ098
NITROGEN	HQ099

## Technical data

CODE	Q max.	P <sub>1</sub> max.	P <sub>2</sub>	INLET CONNECTION	OUTLET CONNECTION	WEIGHT
HQ095	72 Nm <sup>3</sup> /h	200 bar	9 bar	W21,7x1/14" 'A'	Ø 16 mm weld-on pipe	16,0 kg
HQ096	72 Nm <sup>3</sup> /h	200 bar	9 bar	W24,5x1/14" 'B'	Ø 16 mm weld-on pipe	16,0 kg
HQ097	72 Nm <sup>3</sup> /h	200 bar	9 bar	G3/8" 'A'	Ø 16 mm weld-on pipe	16,0 kg
HQ098	72 Nm <sup>3</sup> /h	200 bar	9 bar	W27x2 'A'	Ø 16 mm weld-on pipe	16,0 kg
HQ099	72 Nm <sup>3</sup> /h	200 bar	9 bar	W21,7x1/14" 'B'	Ø 16 mm weld-on pipe	16,0 kg

## Technical Images

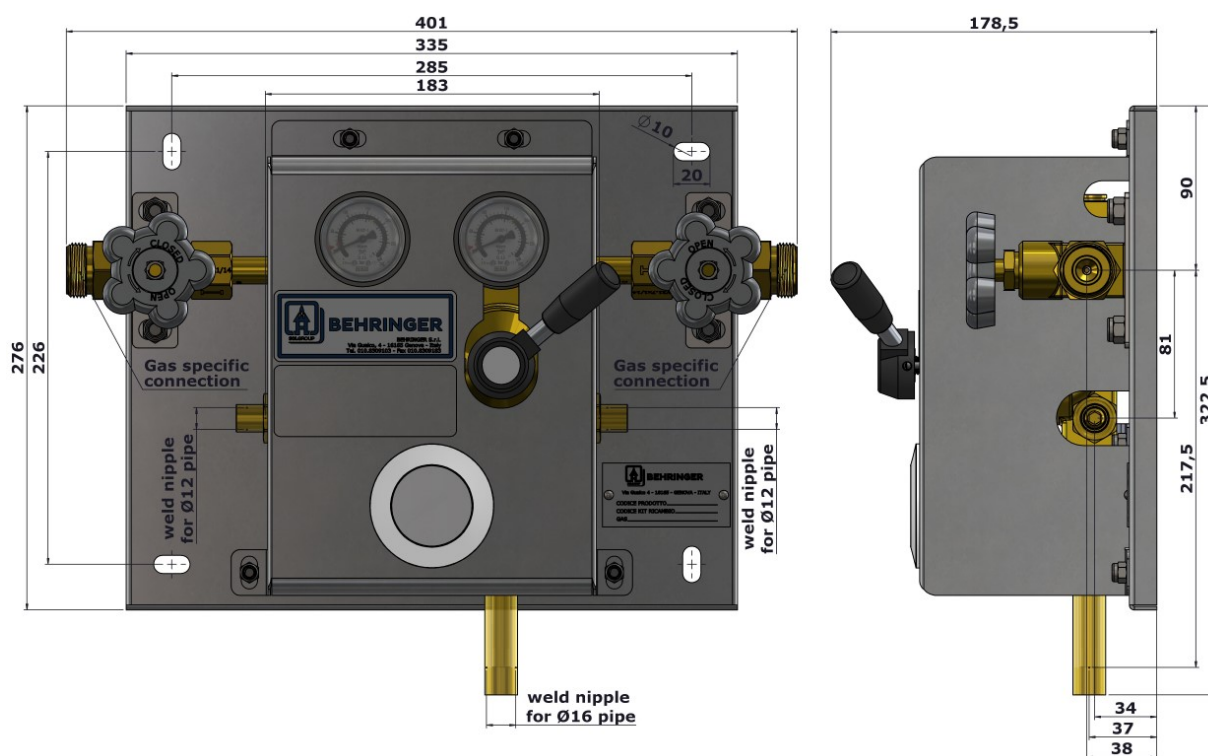

Behringer S.r.l. via Gualco 4, 16165 Genova ITALY

T +39 010 8309103

F +39 010 8309183

e-mail info@behringer.it

C.F. e P.I. 01167840998

